

OCCORRENZA

TAV. 4

Scale:

VARIE

URBANIZZAZIONI IN PROGETTO (Opere
Stradali - Verde - Parcheggi pubblici -
Infrastruttura pubblica)

I Proprietari

STUDIO RINALDIS

Il Progettista:

Ing. Camillo RINALDIS

Via Polveriera - via Monti

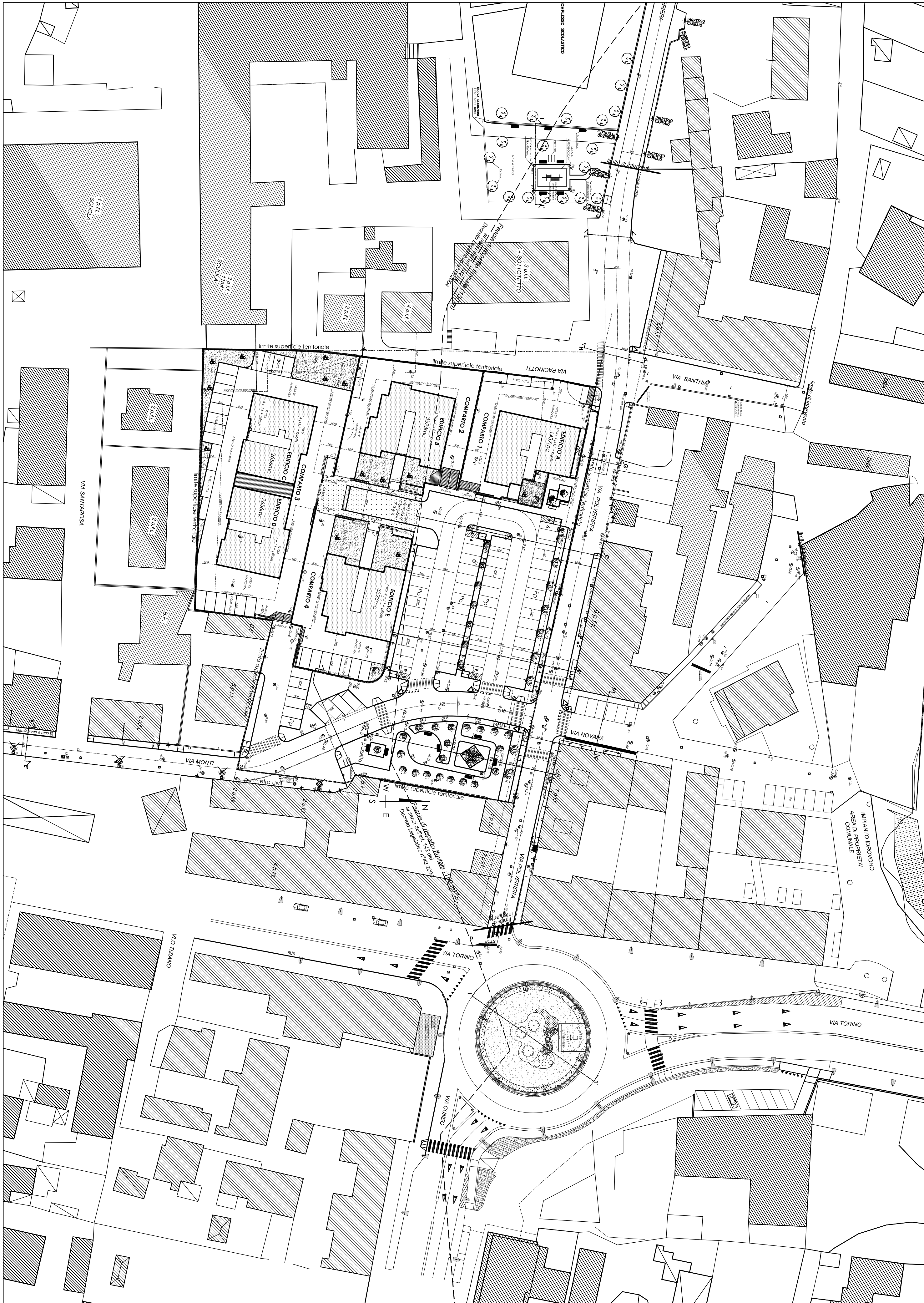

SEZIONE AA'

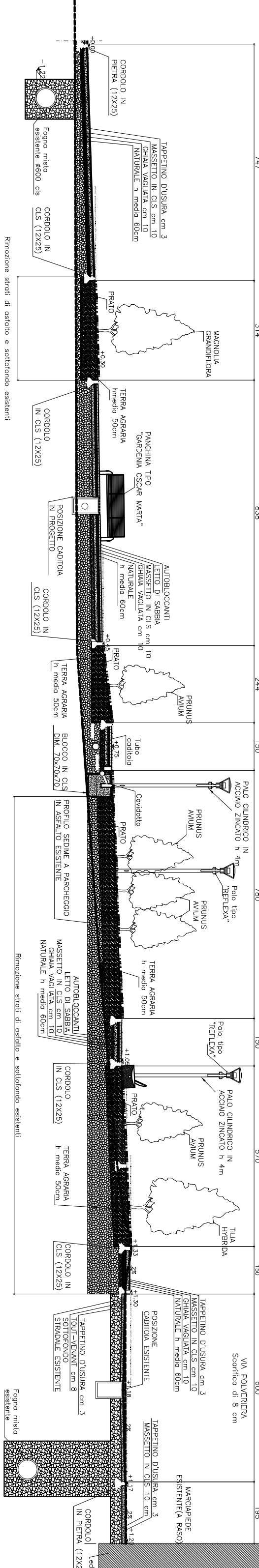

SEZIONE BB'

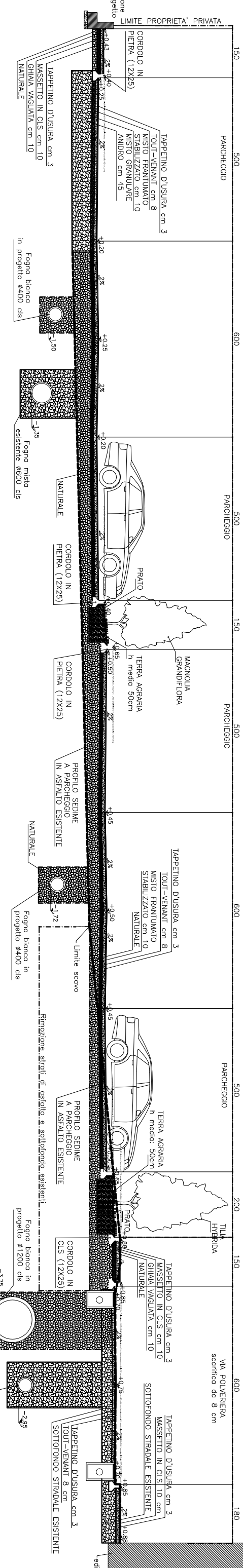

SEZIONE CC'

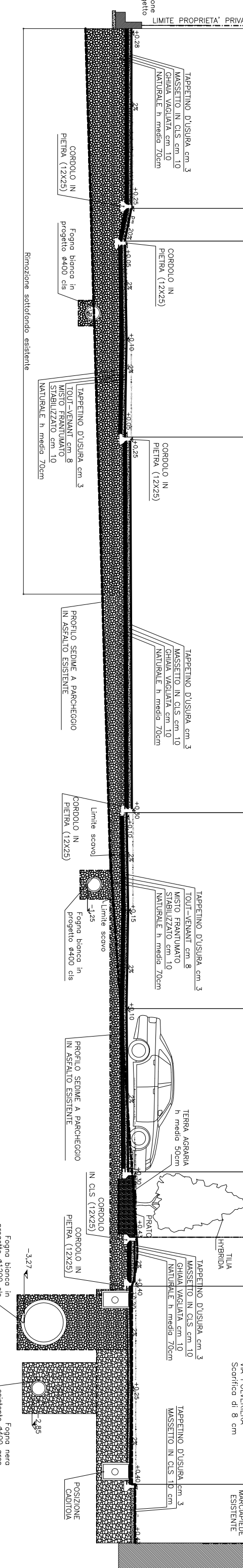

SEZIONE DD'

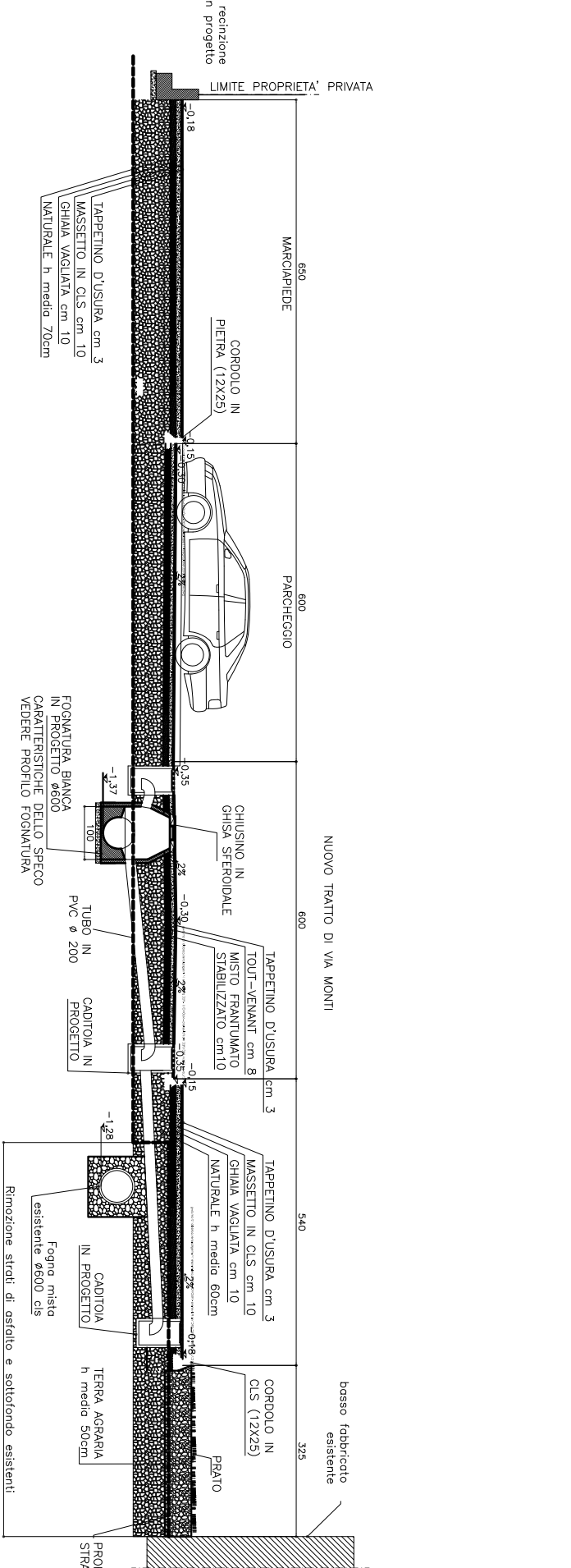

SEZIONE EE'

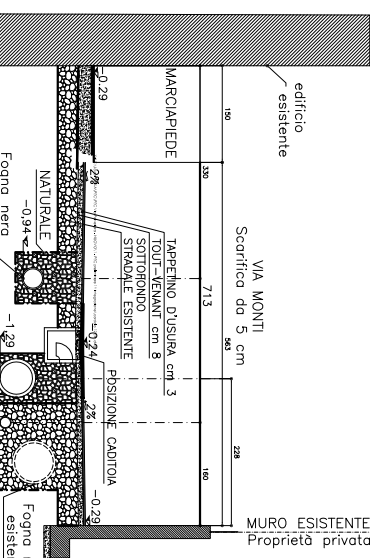

SEZIONE FF'

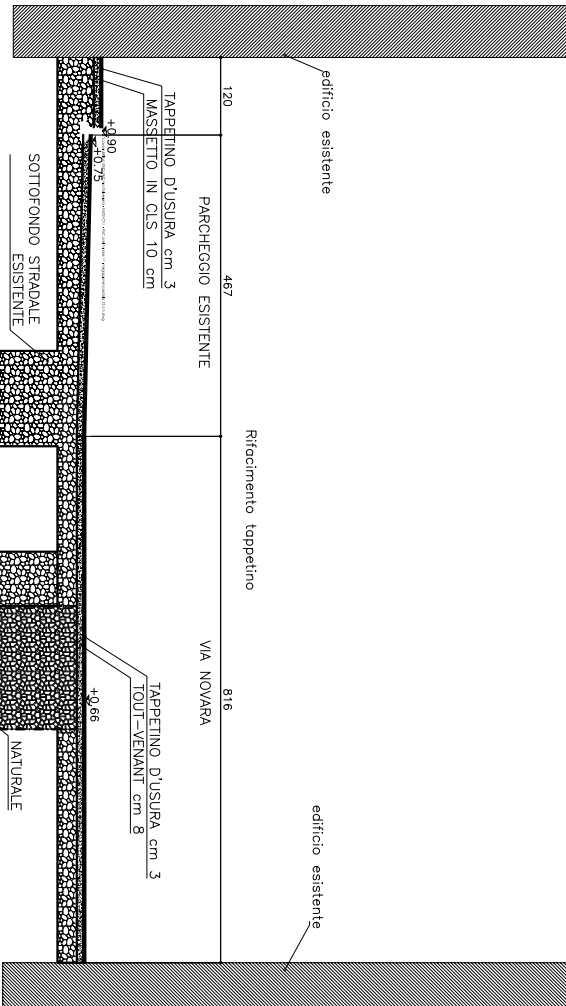

SEZIONE GG'

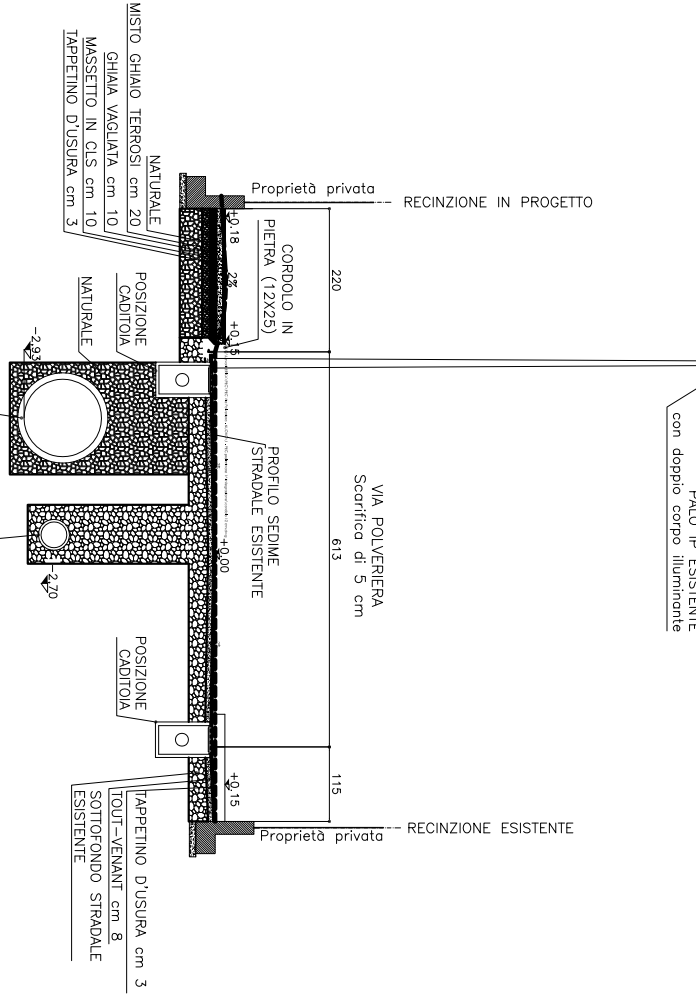

SEZIONE HH'

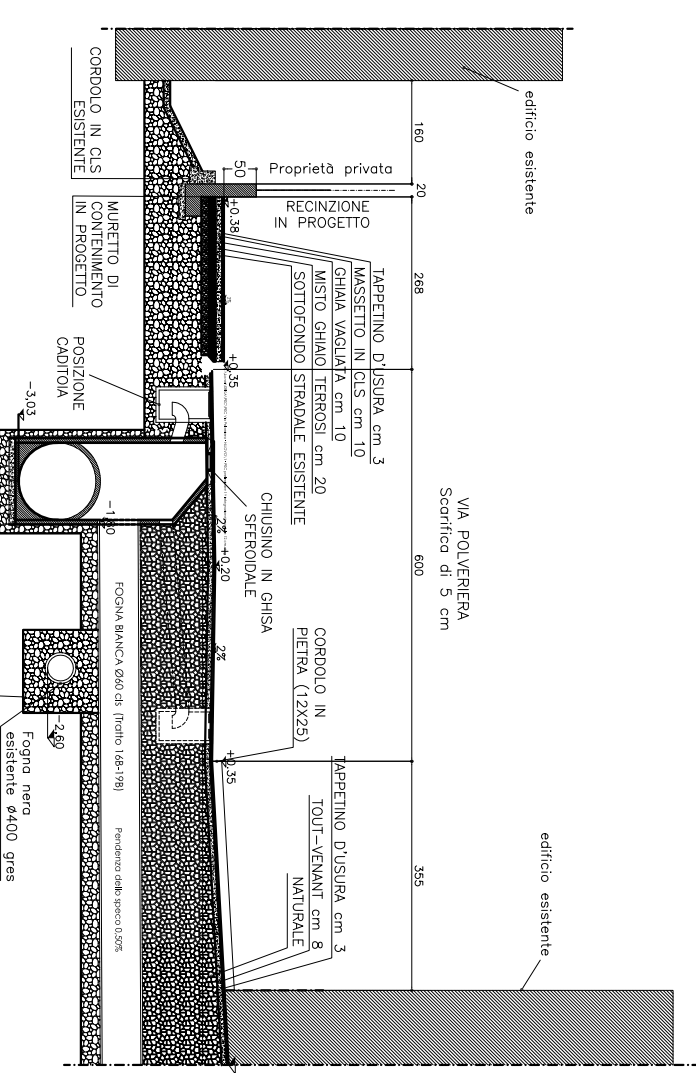

SEZIONE II'

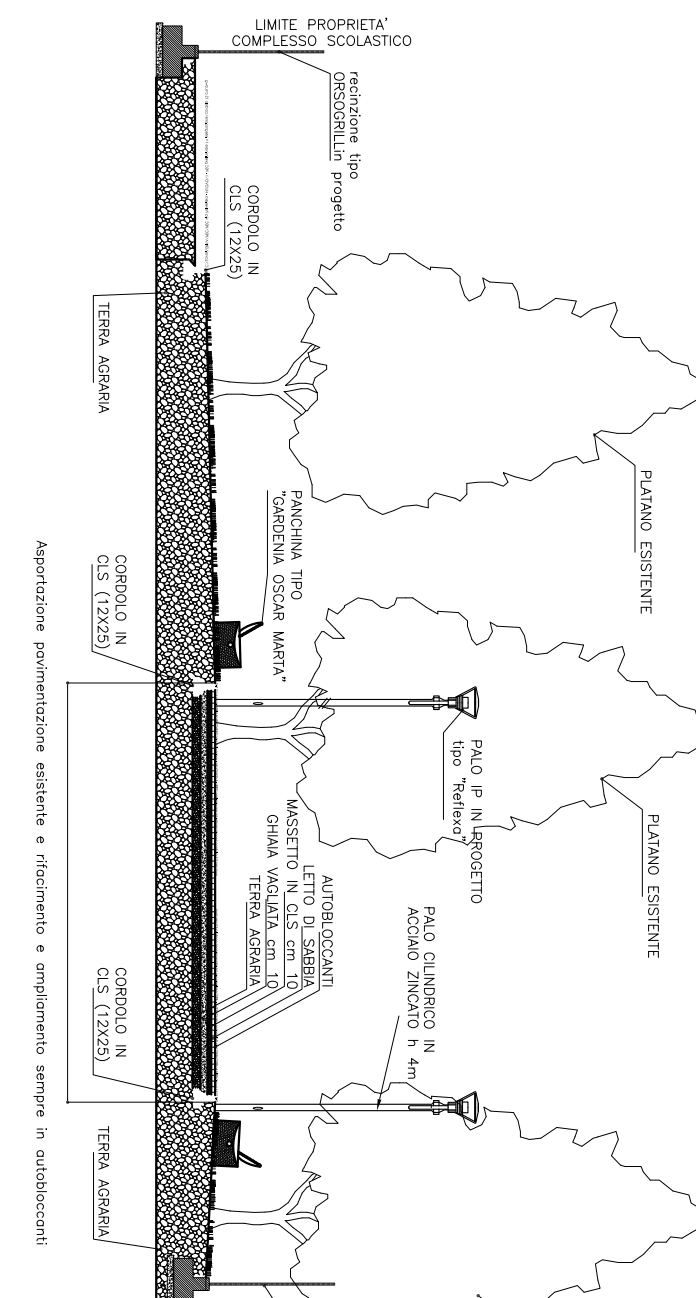

SEZIONE LL'

